

# NBS-Rotatorcarriage 1

Heavy-duty galvanised rotator carriage assembly for NBS-Tiltmast

Dual securing plates for extensions pole or rotator - 1000mm

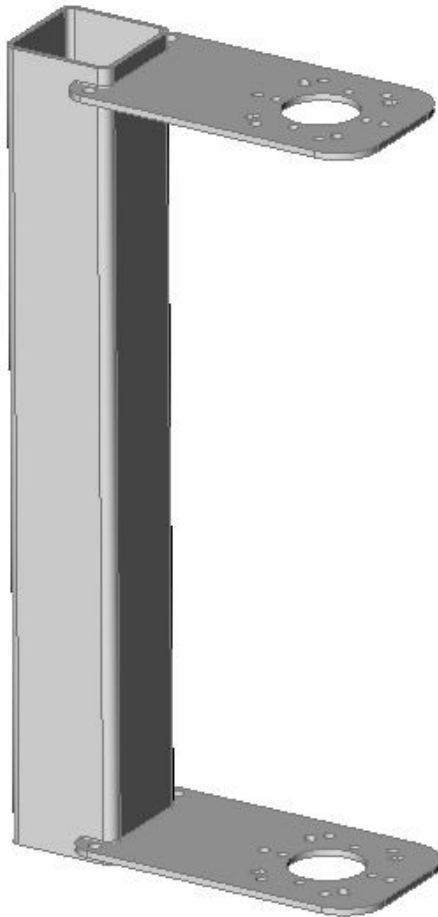

## Specifications

Construction	Fully-galvanised steel SHS tube and dual securing plates with rotator mount and through holes/slots
Suitable mast	NBS-Tiltmast with NBS-Toppulley mount + NBS-RBW**** hand crank winch and 2.0-8.0m 80mm SHS extension pole
Overall Dimensions	Overall height: 1000mm Between plate spacing: 958mm Plate Mount holes: 6 x 10mm & 4 x 9mm Plate Mount slots: 4 x 9mm x 13.5mm Rotator through hole: 66mm
Weight	14.6kg
Winch cable connect holes	2 x 12mm per plate, also can be used on top plate to route cable to stop rotator/antenna interference
Suitable Accessories	NBS-RC Mount kit NBS-RC Bush kit NBS-RBW**** series NBS-Toppulley mount

